

COIN MECHANISM Figure4 Coin Mechanism

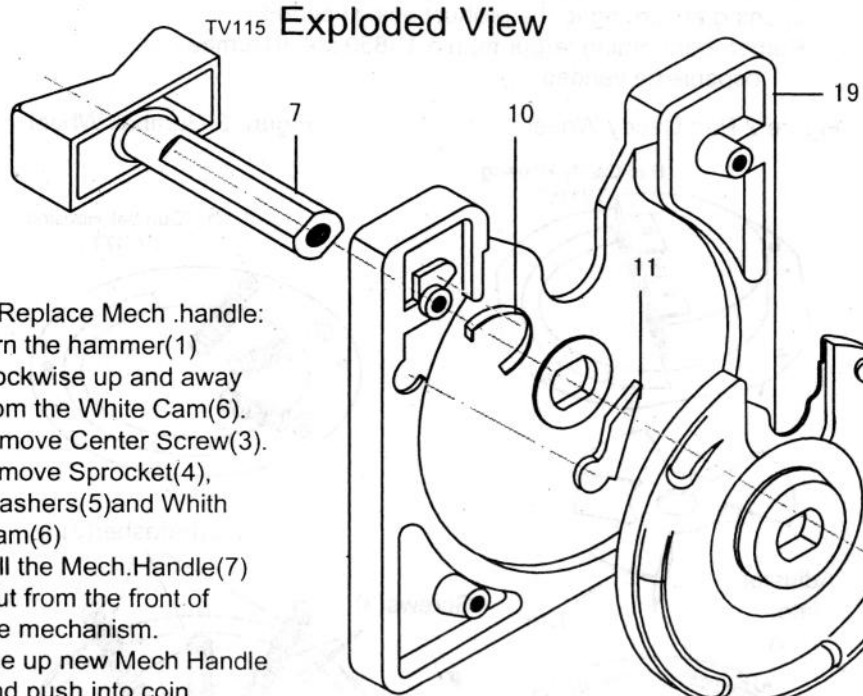

TV115 Exploded View

1. TO Replace Mech .handle:
 - A.) Turn the hammer(1) clockwise up and away from the White Cam(6).
 - B.) Remove Center Screw(3).
 - C.) Remove Sprocket(4), Washers(5)and White Cam(6)
 - D.) Pull the Mech.Handle(7) Out from the front of the mechanism.
 - E.) Line up new Mech Handle and push into coin mechanism.
 - F.) Align the White Cam(6)with finger pointing puward.
 - G.) Replace Washers(5).
 - H.) Replace Sprocket(4).
 - I.) Replace Screw(3)and tighten.
 - J.) Return Hammer(1)to its staring position.

2. To Remove Coin Mechanism From Unit
 - A) Unlock and open rear door
 - B) Locate the backside of the desued coin mechanism inside the unit Locate and loosen the Cap Screw(8)so the Locking Lever(9)will move freely.
 - C) From behind the machine reach around and hold the Mechanism Handle to prevent it from falling. With screwdriven turn the Locking Lever(9)clockwise so it clears the flange and remove.

3. To Reinstall
 - A) Place right side of mechanism into front of machine and swing into place and reverse lrder of steps above.

Illustration for Adjustment & Maintenance Use Only. Coin Mechanism Parts Not Sold Separately.

Part Identification list

1. Hammer	8. Cap Screw	14. Mounting Screw
2. Hammer Spring	9. Locking Lecer	15. Back Plate
3. Center Screw	10. Coin Detector Dog	16. Coin Wheel
4. Sprocket	Spring	17. Washer Detector
5. Washers(quantity may vary)	11. COin Detector Dog	18. Anti-Reverse
6. White Cam	12. Mounting Screw	"T" Pin
7. Mechanism Handele	13. Mounting Screw	19. Mechanism Face Plate

